

**CITY OF ANAHEIM
TRAFFIC CONTROL GENERAL NOTES:**

1. THE CONTRACTOR SHALL OBTAIN ALL REQUIRED CITY PERMITS FROM THE DEPARTMENT OF PUBLIC WORKS BEFORE COMMENCING ANY TRAFFIC CONTROL WORK IN THE PUBLIC RIGHT-OF-WAY, INCLUDING LANE CLOSURES.
2. ALL TRAFFIC CONTROL OUTSIDE OF THE CITY OF ANAHEIM RIGHT-OF-WAY WILL REQUIRE APPROVAL FROM THAT JURISDICTION (I.E. CALTRANS, FULLERTON, BUENA PARK, ORANGE, ETC.). APPROVAL FROM CITY OF ANAHEIM PERMITS TRAFFIC CONTROL WITHIN THE CITY OF ANAHEIM RIGHT-OF-WAY ONLY.
3. WORK HOURS SHALL BE LIMITED TO 8:30 AM - 3:30 PM. ALL VEHICULAR TRAVEL LANES SHALL BE OPEN FROM 7:00AM TO 8:30AM AND FROM 3:30PM TO 6:00PM, UNLESS OTHERWISE NOTED ON THE PLANS OR APPROVED BY PUBLIC WORKS INSPECTOR. TRAFFIC CONTROL DEVICES SHALL BE REMOVED BY THE END OF THE WORK DAY. TRAFFIC AND TRAVEL LANES SHALL BE RESTORED TO NORMAL CONDITIONS DURING NON-WORKING HOURS.
4. CONSTRUCTION SIGNS, BARRICADES, DELINEATORS, WARNING LIGHTS, CHANGEABLE MESSAGE SIGNS, ARROW BOARDS, AND ALL OTHER DEVICES USED TO IMPLEMENT THE PLAN SHALL CONFORM TO THE LATEST VERSION OF THE WORK AREA TRAFFIC CONTROL HANDBOOK (WATCH) AND THE CALIFORNIA MANUAL ON UNIFORM TRAFFIC CONTROL DEVICES (CAMUTCD).
5. ALL TEMPORARY STRIPING AND MARKINGS SHALL CONFORM TO THE CURRENT EDITION OF THE CALIFORNIA MANUAL ON UNIFORM TRAFFIC CONTROL DEVICES AND CITY OF ANAHEIM STANDARDS.
6. THE CONTRACTOR SHALL HAVE ALL SIGNS, BARRICADES, DELINEATORS, WARNING LIGHTS, CHANGEABLE MESSAGE SIGNS, ARROW BOARDS, AND OTHER DEVICES PROPERLY INSTALLED PRIOR TO COMMENCING CONSTRUCTION. THE CONTRACTOR SHALL COVER ALL CONFLICTING REGULATORY SIGNS.
7. ADDITIONAL TRAFFIC CONTROLS, SIGNS, DELINEATORS OR BARRICADES MAY BE REQUIRED IN THE FIELD. THE CONTRACTOR SHALL BE RESPONSIBLE FOR THE PLACEMENT OF ANY ADDITIONAL DEVICES NECESSARY TO ASSURE SAFETY TO THE PUBLIC AT ALL TIMES DURING CONSTRUCTION.
8. FLASHING YELLOW BEACONS SHALL BE USED ON ALL ADVANCE WARNING SIGNS, AND ALL TYPE II AND III BARRICADES GUARDING THE WORK AREA OVERNIGHT.
9. ALL SIGNS SHALL BE REFLECTORIZED AND STANDARD SIZE.
10. ALL DELINEATORS SHALL BE 28" MINIMUM PORTABLE, REFLECTORIZED AND MAINTAINED ERECT IN INDICATED POSITION AT ALL TIMES, AND SHALL BE REPAIRED, OR CLEANED AS NECESSARY TO PRESERVE THEIR APPEARANCE AND CONTINUITY.
11. THE CONTRACTOR SHALL MAINTAIN ON A 24-HOUR BASIS ALL SIGNS, DELINEATORS, BARRICADES, ETC., TO INSURE PROPER FLOW AND SAFETY OF TRAFFIC. A MINIMUM OF ONE PERSON SHALL BE ASSIGNED TO PROVIDE FULL-TIME CONTINUOUS MONITORING AND MAINTENANCE OF TRAFFIC CONTROL DEVICES. THE ASSIGNED PERSON SHALL PROVIDE THEIR CONTACT INFORMATION ON THE APPROVED PLANS AND/OR THE INSPECTOR ASSIGNED TO THE WORK.
12. ALL CONFLICTING STRIPING, MARKINGS AND LEGENDS SHALL BE COMPLETELY REMOVED BY WET SANDBLASTING, OR OTHER METHOD APPROVED BY THE PUBLIC WORKS INSPECTOR.
13. THE CONTRACTOR SHALL PROVIDE ACCESS TO ALL ADJACENT PROPERTIES DURING WORK HOURS. CONSTRUCTION OPERATIONS SHALL BE CONDUCTED IN SUCH A MANNER AS TO CAUSE AS LITTLE INCONVENIENCE AS POSSIBLE TO ADJUTING PROPERTY OWNERS/OPERATORS.
14. THE CONTRACTOR SHALL PROVIDE FOR SAFE AND ADA-COMPLIANT PEDESTRIAN ACCESS AT ALL TIMES.
15. POST "TEMPORARY NO PARKING TOW AWAY" SIGNS DEFINING THE TIME AND DATE OF ANY SUCH RESTRICTION 72 HOURS PRIOR TO WORK. NOTIFY ANAHEIM POLICE DEPARTMENT DISPATCH (714) 765-1900 (GIVE LOCATION AND DURATION) 72 HOURS PRIOR TO WORK FOR ENFORCEMENT.
16. THE CONTRACTOR SHALL BE RESPONSIBLE FOR LOCATION AND PROTECTION OF TRAFFIC SIGNAL LOOP-SENSORS AND SIGNAL AND INTERCONNECT CONDUITS. WHERE DAMAGE IS CAUSED BY THE CONTRACTOR'S OPERATION, THE CONTRACTOR SHALL REPLACE DAMAGED CITY FACILITY WITHIN 5 CALENDAR DAYS AT NO COST TO THE CITY OF ANAHEIM.
17. THE FOLLOWING AGENCIES SHALL BE NOTIFIED 48 HOURS IN ADVANCE OF ANY DETOUR AND/OR CONSTRUCTION ACTIVITIES:
CITY OF ANAHEIM FIELD ENGINEER/INSPECTION (714) 765-5126;
CITY OF ANAHEIM TRAFFIC MANAGEMENT CENTER (714) 765-5202;
CITY OF ANAHEIM POLICE DEPARTMENT DISPATCH (714) 765-1900, GIVE LOCATION AND DURATION;
CITY OF ANAHEIM FIRE DEPARTMENT (714) 765.4000
ORANGE COUNTY TRANSPORTATION AUTHORITY (714) 265-4331;
ANAHEIM RESORT TRANSPORTATION (714) 563-2312
18. FOR TRAFFIC SIGNAL ASSISTANCE, SIGNAL SERVICES REQUEST FORM MUST BE FILLED OUT COMPLETELY AND SUBMITTED 48 HOURS (2 BUSINESS DAYS) PRIOR TO WORK. CONTACT TMC AT (714) 765-5202.
19. CONTRACTOR SHALL CONTACT ORANGE COUNTY TRANSPORTATION AUTHORITY AT (714) 265-4331 AND ANAHEIM RESORT TRANSPORTATION AT (714) 563-2312 AT LEAST 48 HOURS PRIOR TO ANY BUS STOP CLOSURES AND/OR RELOCATIONS DURING CONSTRUCTION ACTIVITIES.
20. THE CONTRACTOR SHALL REMOVE ALL TRAFFIC CONTROL DEVICES AND OPEN ALL TRAVEL LANES THREE HOURS PRIOR TO START OF ANY EVENT(S) AT THE ANAHEIM RESORT, THE ANGEL STADIUM AND/OR THE HONDA CENTER. THE CONTRACTOR SHALL CONTACT THE ANAHEIM TRAFFIC MANAGEMENT CENTER (TMC) AT (714) 765-5202 FOR UPDATED LIST OF EVENTS.
21. FOR CONSTRUCTION WITHIN THE ANAHEIM RESORT AND PLATINUM TRIANGLE AREAS, THE CONTRACTOR SHALL COORDINATE THE WORK SCHEDULE AT WEEKLY ANAHEIM TMC EVENTS MEETINGS. WORK SCHEDULE IS SUBJECT TO APPROVAL PENDING EVENTS AND OTHER CONTRACTORS WORKING IN THE AREAS CONTACT TMC TO ADD YOUR PROJECT TO THE MEETING AGENDA.
22. CITY INSPECTOR AND OFFICIALS MAY DISCONTINUE OPERATIONS AT ANY TIME IF THE INSPECTOR DETERMINES THAT THE WORK CREATES AN UNDUCE SAFETY RISK OR SEVERE TRAFFIC CONGESTION.
23. CONTRACTOR SHALL NOTIFY ANY FIRE STATION, POLICE STATION, SCHOOL, AND HOSPITAL AFFECTED BY CONSTRUCTION ACTIVITIES.

CITY OF ANAHEIM

TRAFFIC CONTROL PLANS

for

THE WIDENING OF LINCOLN AVENUE

FROM EAST STREET TO EVERGREEN STREET

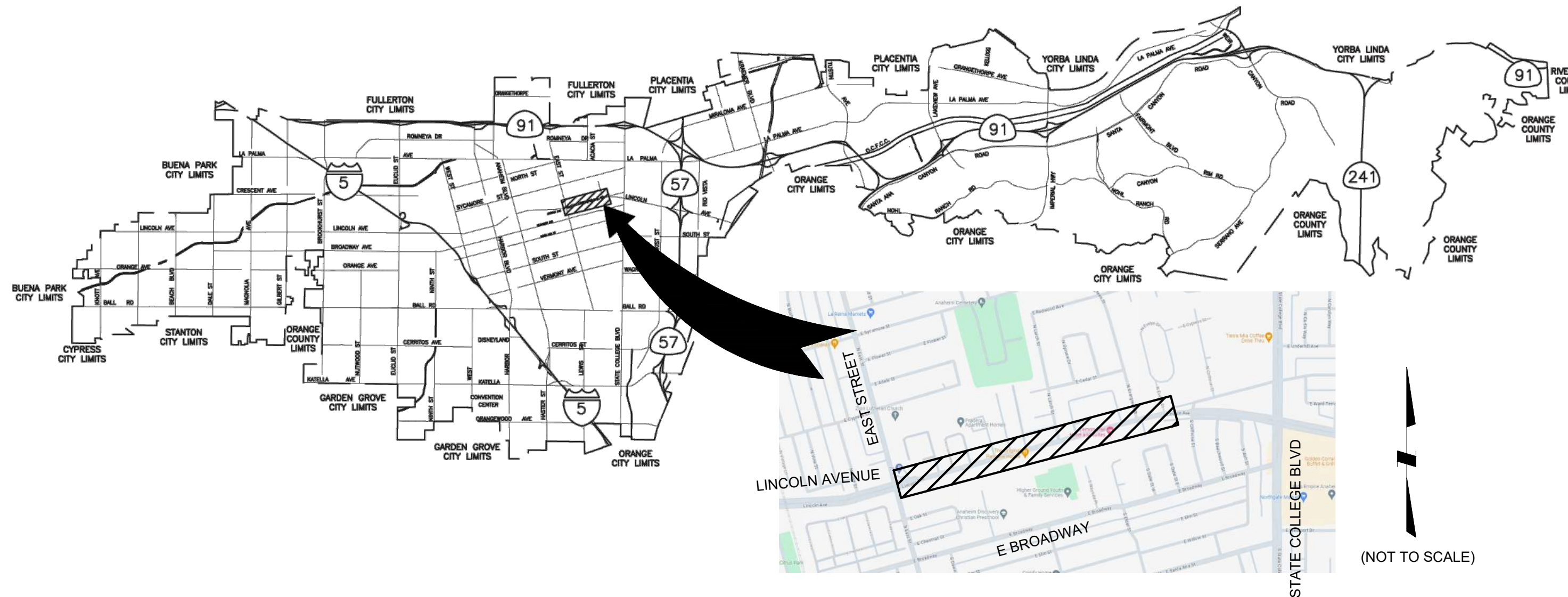

MISCELLANEOUS DEVICES

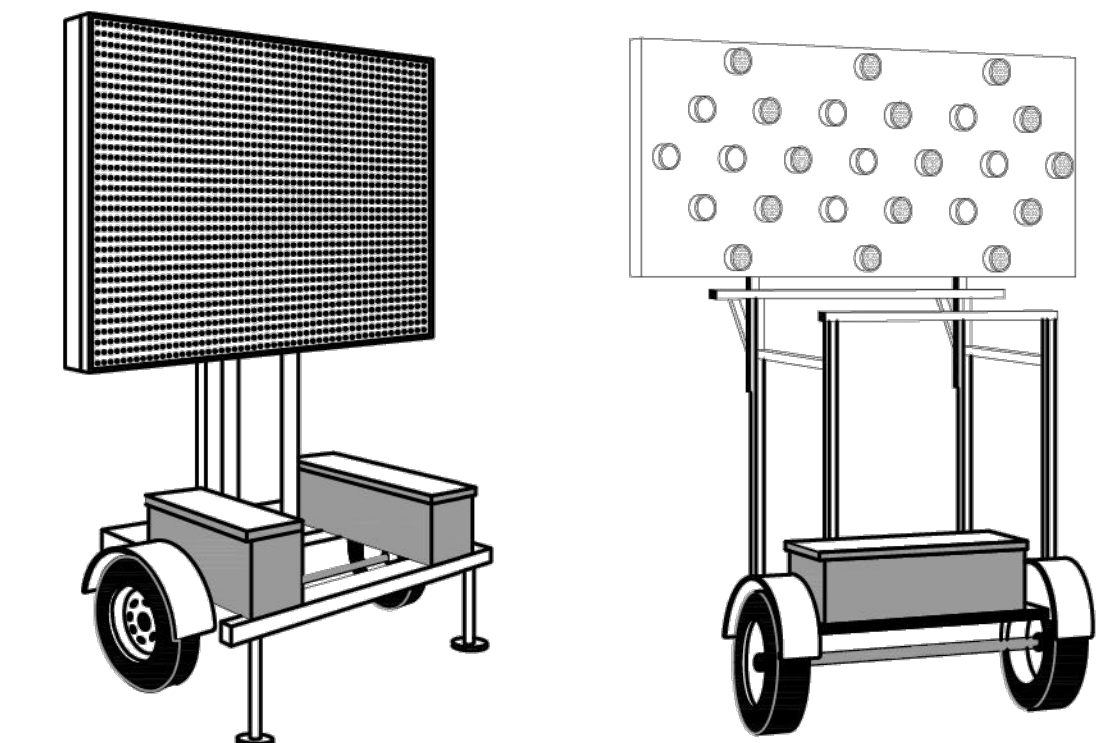

CHANGEABLE MESSAGE SIGN TRAILER (TYP.) (CMS) FLASHING ARROW SIGN TRAILER (TYP.) (FAS)

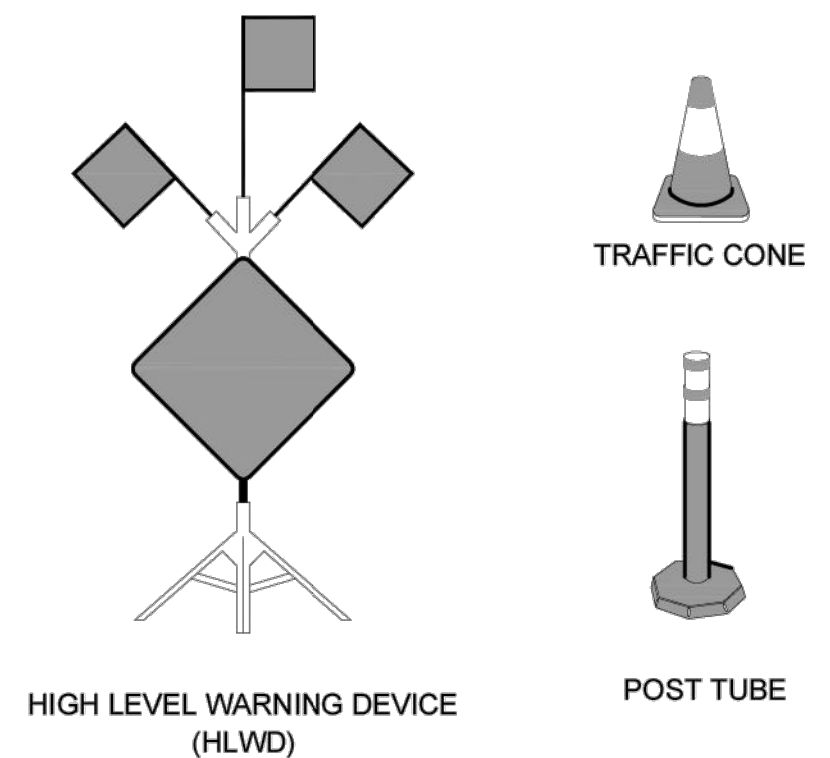

HIGH LEVEL WARNING DEVICE (HLWD)

POST TUBE

TRAFFIC CONE

LEGEND:

1. [Symbol] - PROPOSED WORK AREA
2. [Symbol] - EXISTING STRIPING
3. [Symbol] - EXISTING CURB & GUTTER
4. [Symbol] - MUNICIPALITY BOUNDARY LINES
5. [Symbol] - EXISTING DRIVEWAY(S)
6. [Symbol] - CALTRANS BOUNDARY LINES
7. [Symbol] - PROPOSED CHANNELIZATION LINE
8. [Symbol] - EXISTING FENCE LINE
9. [Symbol] - PROPOSED FLAG PERSON W/ 2-WAY RADIO
10. [Symbol] - PROPOSED PORTABLE ARROW BOARD
11. [Symbol] - PROPOSED PORTABLE MESSAGE SIGN
12. [Symbol] - PROPOSED SIGN W/ POST
13. [Symbol] - PROPOSED TYPE II BARRICADE W/ SIGN(S)
14. [Symbol] - PROPOSED TYPE III BARRICADE W/ SIGN(S)
15. [Symbol] - K-RAIL
16. [Symbol] - CRASH CUSHION

WARNING SIGNS

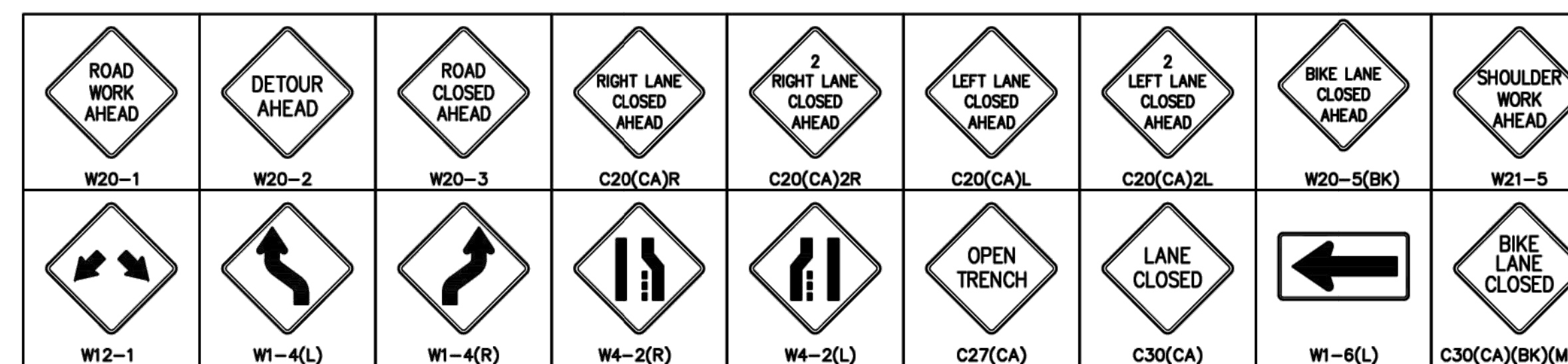

REGULATORY SIGNS

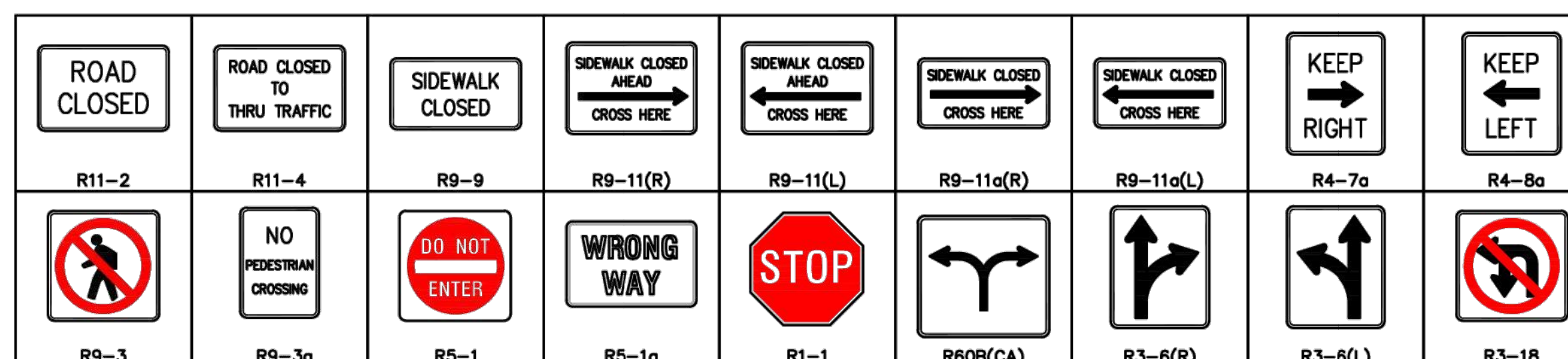

SPEED LIMIT	DIMENSION "A" ADVANCE WARNING SIGN SPACING	DIMENSION "L" MERGING TAPER LENGTH	DIMENSION "L2" SHIFTING TAPER LENGTH	DIMENSION "E" BUFFER SPACE (0% SLOPE)	MAXIMUM CHANNELIZER TAPER SPACING	MAXIMUM CHANNELIZER TANGENT SPACING
25 MPH	100 FT	125 FT	65 FT	155 FT	25 FT	50 FT
30 MPH	250 FT	180 FT	90 FT	200 FT	30 FT	60 FT
35 MPH	250 FT	245 FT	125 FT	250 FT	35 FT	70 FT
40 MPH	250 FT	320 FT	160 FT	305 FT	40 FT	80 FT
45 MPH	350 FT	540 FT	270 FT	360 FT	45 FT	90 FT
50 MPH	350 FT	600 FT	300 FT	425 FT	50 FT	100 FT
55 MPH	500 FT	600 FT	300 FT	495 FT	50 FT	100 FT
60 MPH	500 FT	720 FT	360 FT	570 FT	50 FT	100 FT



DESIGN BY: LONG TRAN
REVIEW BY: LONG TRAN
APPROVED BY: HUMAYUN AZIZ, P.E.

MARK REVISIONS APPR. DATE ENGINEER DATE

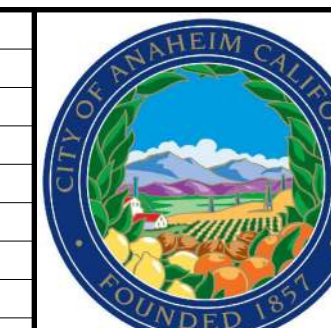

CITY OF ANAHEIM
DEPARTMENT OF PUBLIC WORKS
200 SOUTH ANAHEIM BLVD., #276
ANAHEIM, CA 92805
TEL: 714-765-5176. www.anaheim.net
APPROVED BY: _____ ENGINEER DATE _____

TRAFFIC CONTROL PLAN
THE WIDENING OF LINCOLN AVENUE
FROM EAST STREET TO EVERGREEN STREET
TITLE SHEET
HORIZ. SCALE: 1"= 40' VERT. SCALE: N/A

TC-00

SHEET 01 OF 10

SCALE 1" = 40'

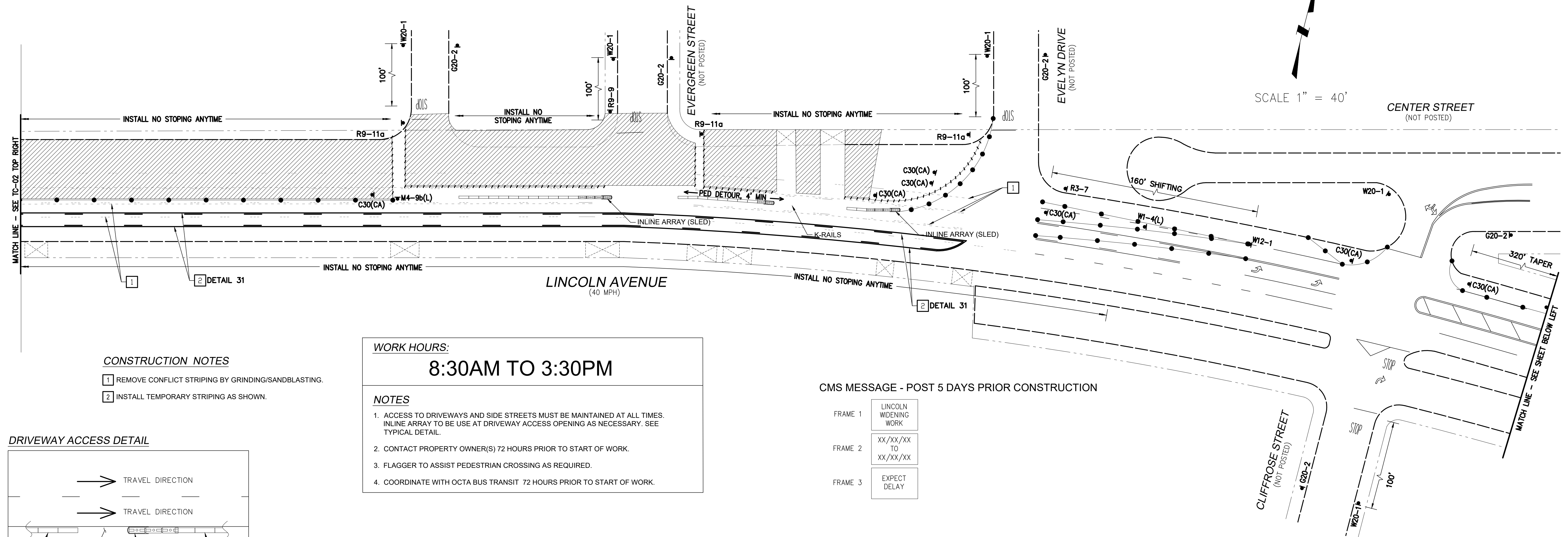

CONSTRUCTION NOTES

- 1 REMOVE CONFLICT STRIPING BY GRINDING/SANDBLASTING.
- 2 INSTALL TEMPORARY STRIPING AS SHOWN.

WORK HOURS:
8:30AM TO 3:30PM

NOTES

1. ACCESS TO DRIVEWAYS AND SIDE STREETS MUST BE MAINTAINED AT ALL TIMES. INLINE ARRAY TO BE USED AT DRIVEWAY ACCESS OPENING AS NECESSARY. SEE TYPICAL DETAIL.
2. CONTACT PROPERTY OWNER(S) 72 HOURS PRIOR TO START OF WORK.
3. FLAGGER TO ASSIST PEDESTRIAN CROSSING AS REQUIRED.
4. COORDINATE WITH OCTA BUS TRANSIT 72 HOURS PRIOR TO START OF WORK.

CMS MESSAGE - POST 5 DAYS PRIOR CONSTRUCTION

- FRAME 1 LINCOLN WIDENING WORK
- FRAME 2 XX/XX/XX TO XX/XX/XX
- FRAME 3 EXPECT DELAY

DRIVEWAY ACCESS DETAIL

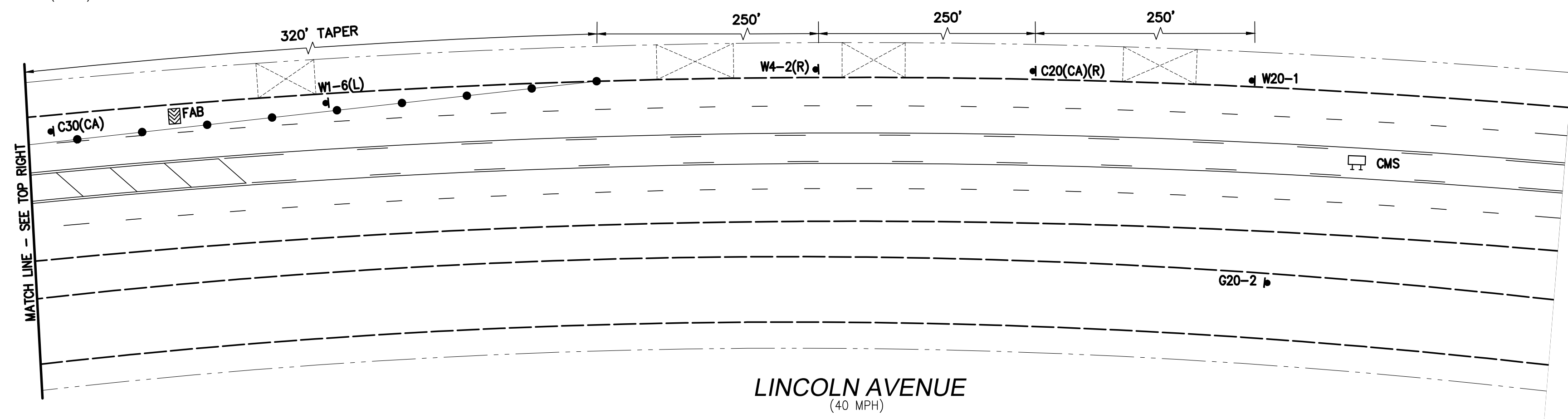
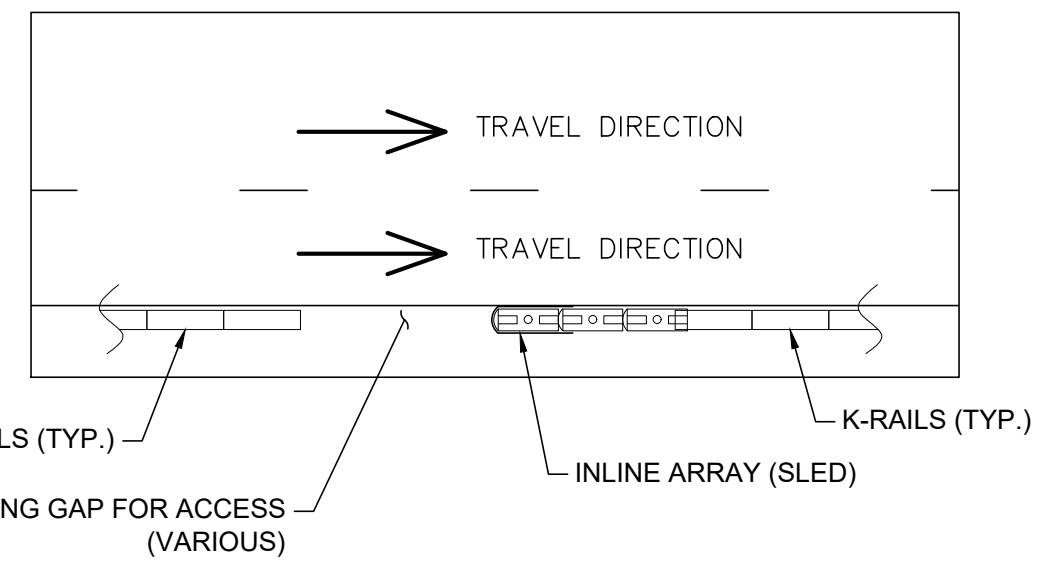

SIGN LEGENDS:

C20(CA)(R)	C20(CA)(L)	C30(CA)	G20-2	M4-9b(L)	R3-4	R3-7
R9-9	R9-11a	W1-4	W1-6(R)	W1-6(L)	W4-2(R)	
W4-2(L)	W12-1	W20-1	FAB			

SCALE 1" = 40'

STAGE 1



DESIGN BY: LONG TRAN
REVIEW BY: LONG TRAN
APPROVED BY: HUMAYUN AZIZ, P.E.

MARK	REVISIONS	APPR.	DATE

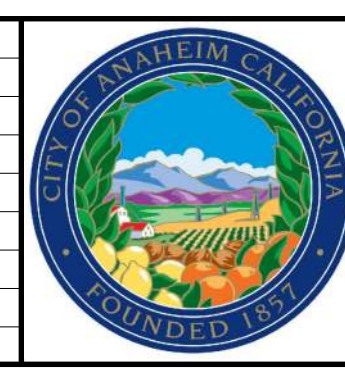

CITY OF ANAHEIM
DEPARTMENT OF PUBLIC WORKS
200 SOUTH ANAHEIM BLVD., #276
ANAHEIM, CA 92805
TEL: 714-765-5176 www.anaheim.net
APPROVED BY: _____ ENGINEER DATE _____

TRAFFIC CONTROL PLAN
THE WIDENING OF LINCOLN AVENUE
FROM EAST STREET TO EVERGREEN STREET
NORTH CURB WIDENING and FULL PAVEMENT RESTORATION
HORIZ. SCALE: 1" = 40' VERT. SCALE: N/A

TC-03
SHEET 04 OF 10

SIGN LEGENDS:

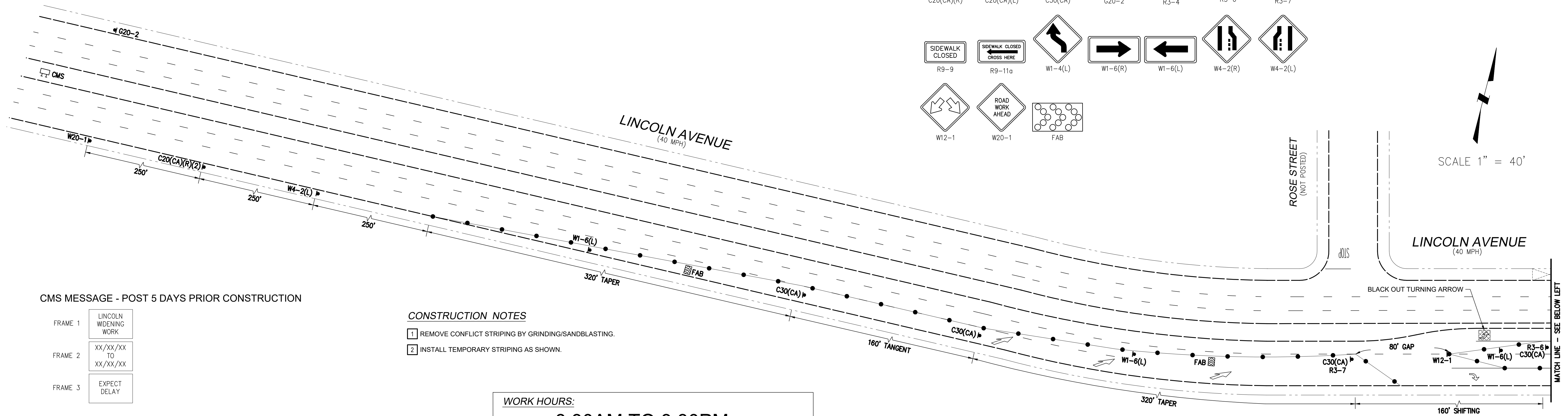
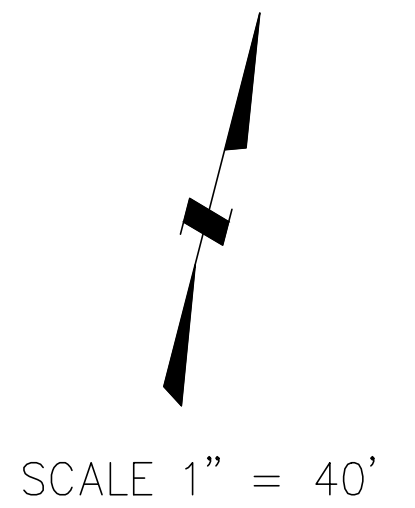
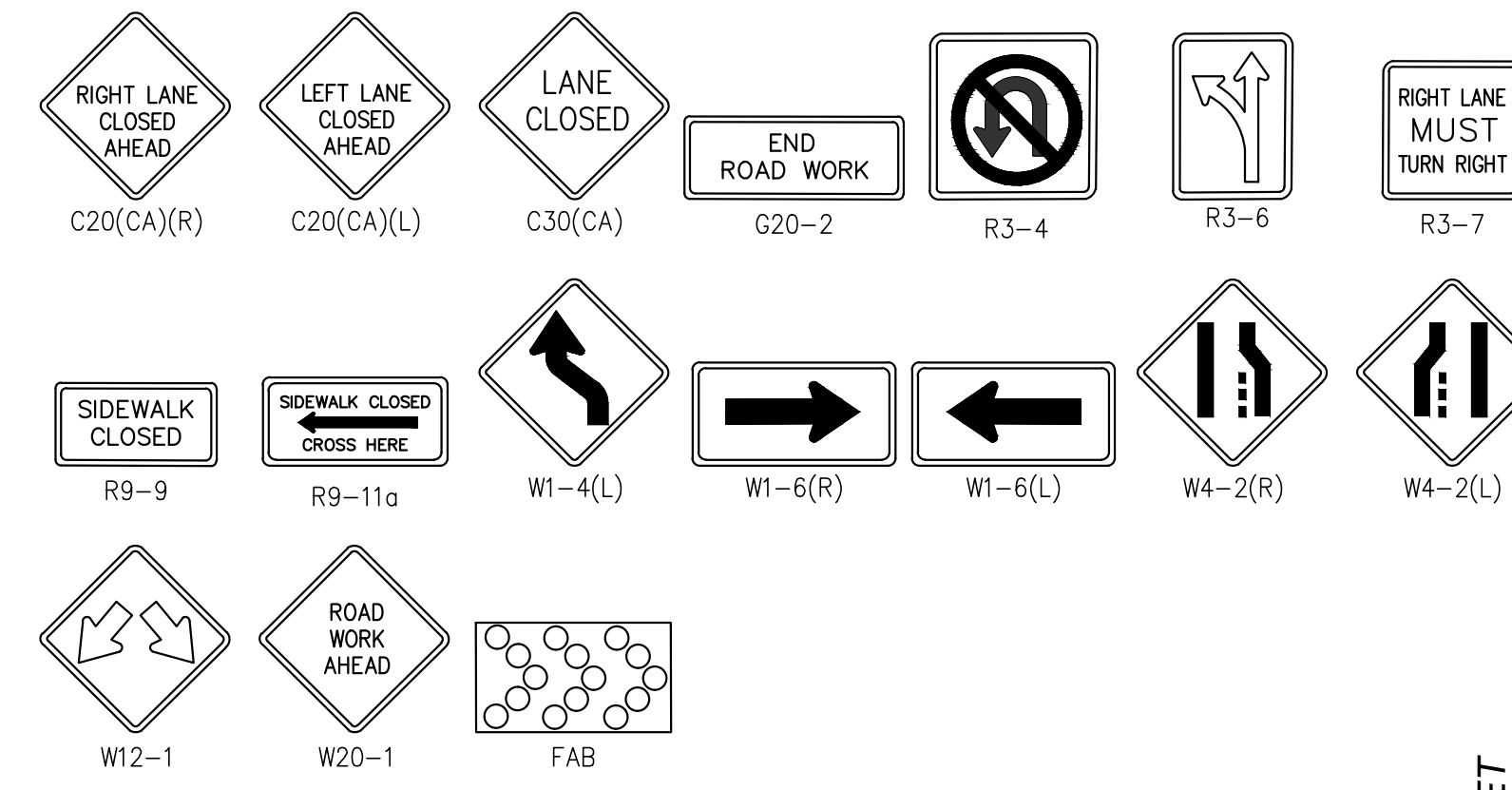

CMS MESSAGE - POST 5 DAYS PRIOR CONSTRUCTION

FRAME 1	LINCOLN WIDENING WORK
FRAME 2	XX/XX/XX TO XX/XX/XX
FRAME 3	EXPECT DELAY

CONSTRUCTION NOTES

- 1 REMOVE CONFLICT STRIPING BY GRINDING/SANDBLASTING.
- 2 INSTALL TEMPORARY STRIPING AS SHOWN.

WORK HOURS:
 8:30AM TO 3:30PM

NOTES

1. ACCESS TO DRIVEWAYS AND SIDE STREETS MUST BE MAINTAINED AT ALL TIMES. INLINE ARRAY TO BE USED AT DRIVEWAY ACCESS OPENING AS NECESSARY. SEE TYPICAL DETAIL.
2. CONTACT PROPERTY OWNER(S) 72 HOURS PRIOR TO START OF WORK.
3. FLAGGER TO ASSIST PEDESTRIAN CROSSING AS REQUIRED.
4. COORDINATE WITH OCTA BUS TRANSIT 72 HOURS PRIOR TO START OF WORK.

DRIVEWAY ACCESS DETAIL

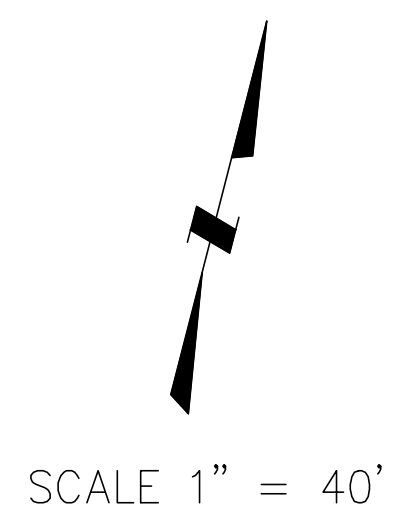
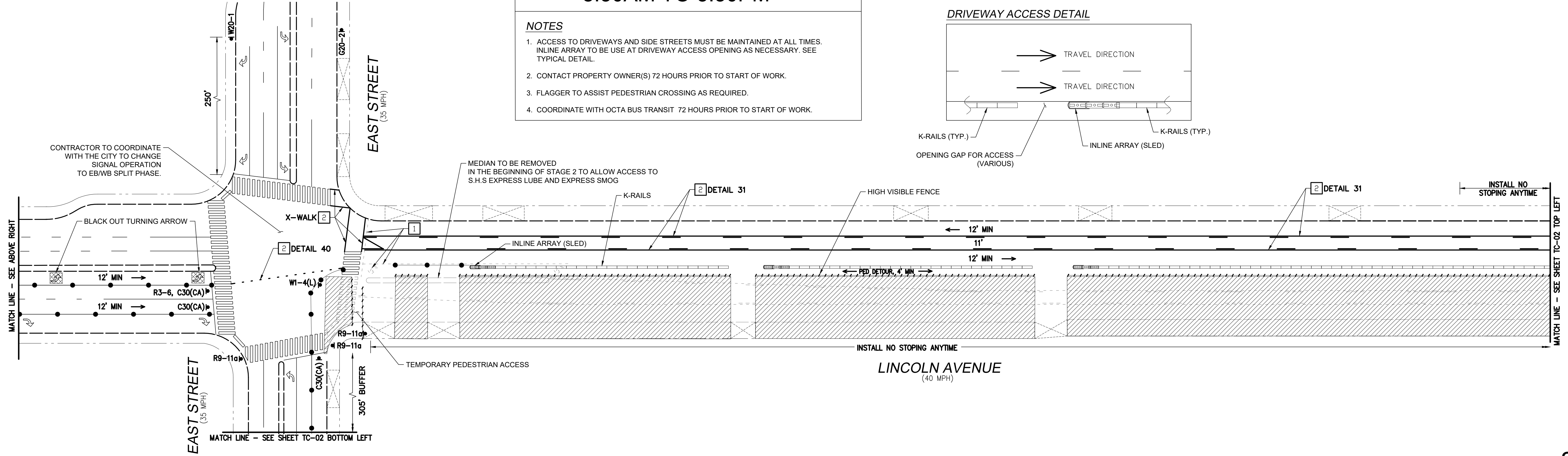
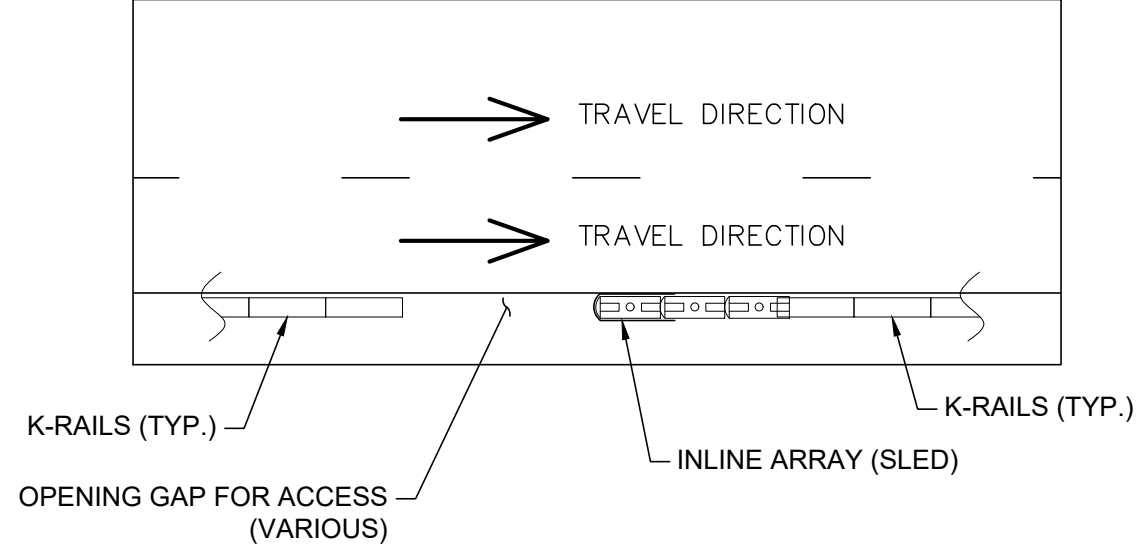

STAGE 2

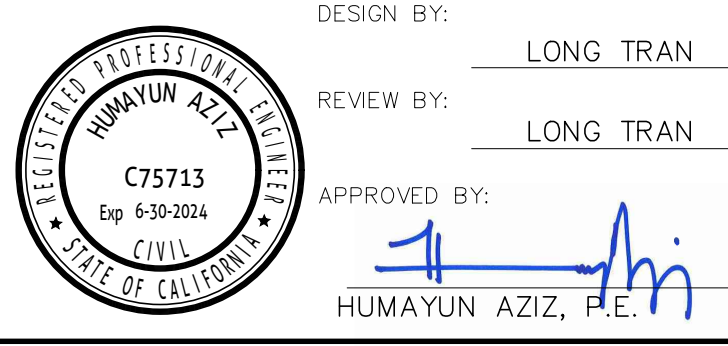

DESIGN BY: LONG TRAN
 REVIEW BY: LONG TRAN
 APPROVED BY: HUMAYUN AZIZ, P.E.

MARK	REVISIONS	APPR.	DATE

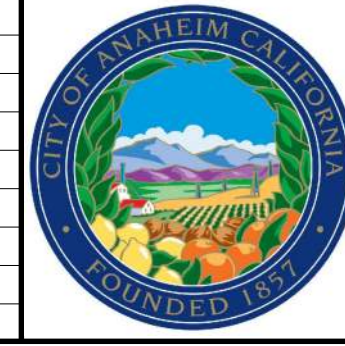

CITY OF ANAHEIM
 DEPARTMENT OF PUBLIC WORKS
 200 SOUTH ANAHEIM BLVD., #276
 ANAHEIM, CA 92805
 TEL: 714-765-5176. www.anaheim.net
 APPROVED BY: _____ ENGINEER DATE _____

TRAFFIC CONTROL PLAN
THE WIDENING OF LINCOLN AVENUE
 FROM EAST STREET TO EVERGREEN STREET
 SOUTH CURB WIDENING and FULL PAVEMENT RESTORATION
 HORIZ. SCALE: 1" = 40' VERT. SCALE: N/A

TC-04
 SHEET 05 OF 10